

OFFICE AVAILABLE FOR LEASE – 850 - 3,900 SF



GLOBAL
COMMERCIAL

5671 Santa Teresa Blvd., San Jose, CA

www.GlobalCommercialProp.com

RALPH LONGO
408-529-1362
DRE #01202211
RLONGO@GLOBALCOMMERCIALPROP.COM

OFFICE AVAILABLE FOR LEASE – 850 - 3,900 SF



Property Highlights

- Excellent South Bay Location
- Walk to Amenities
- Easy 85 / 87 Access
- Walk to Light Rail
- Professional Business Setting
- Lose the Commute

- Call to Tour



GLOBAL
COMMERCIAL

5671 Santa Teresa Blvd., San Jose, CA

www.GlobalCommercialProp.com

RALPH LONGO
408-529-1362
DRE #01202211
RLONGO@GLOBALCOMMERCIALPROP.COM

OFFICE AVAILABLE FOR LEASE – 850 - 3,900 SF

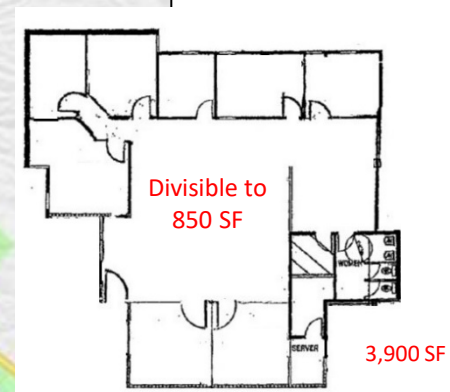
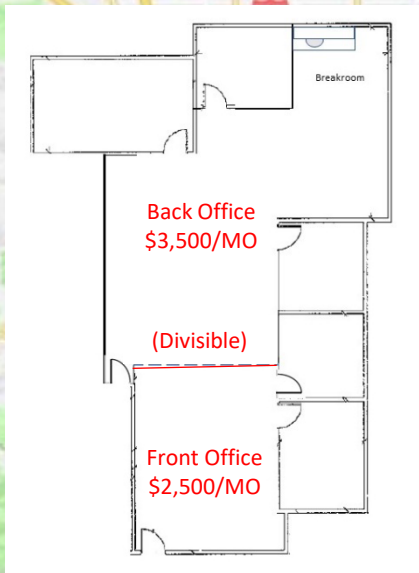
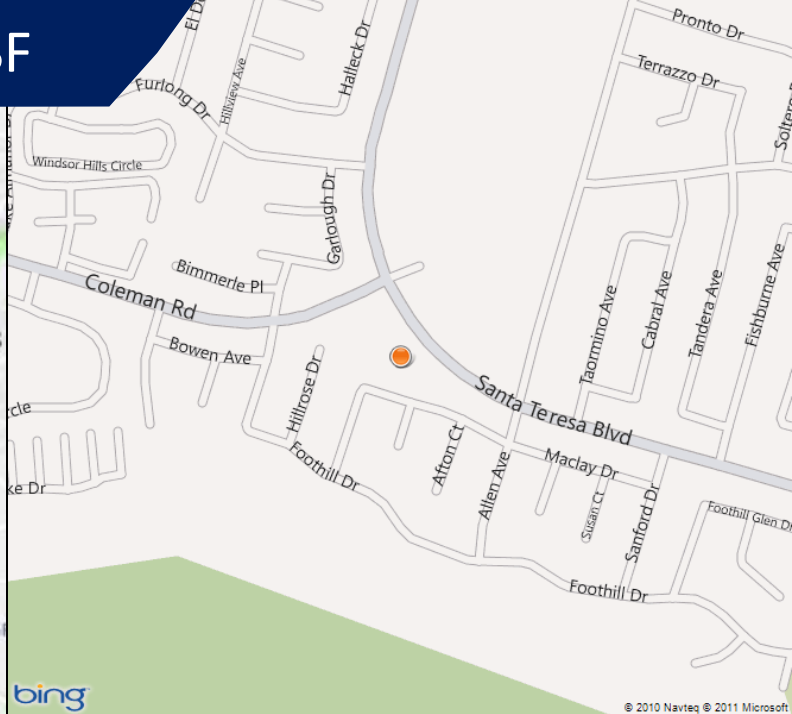
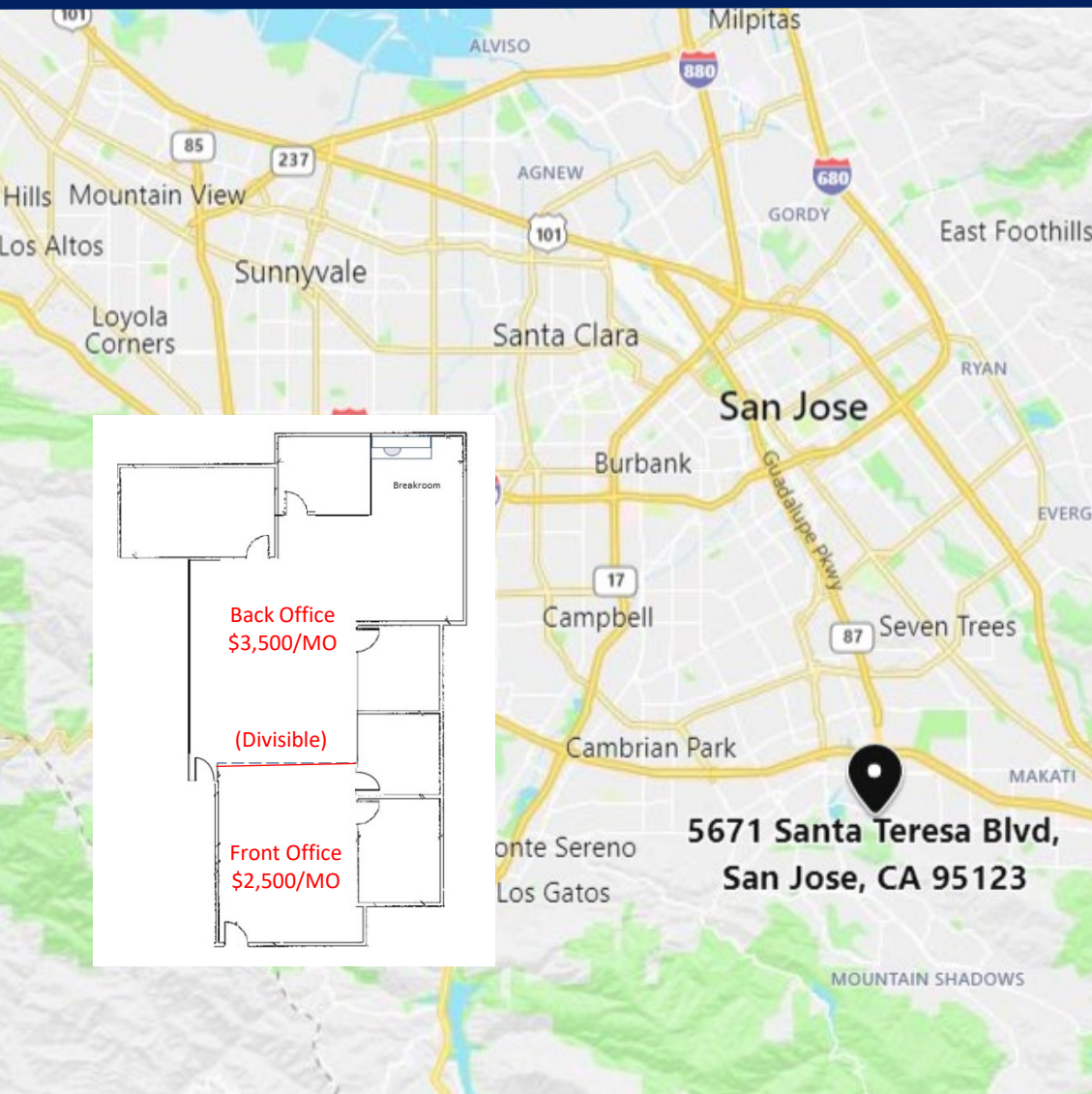

5671 Santa Teresa Blvd., San Jose, CA

www.GlobalCommercialProp.com

RALPH LONGO
408-529-1362
DRE #01202211
RLONGO@GLOBALCOMMERCIALPROP.COM